

ONE BEDROOM SUITE

Plan J

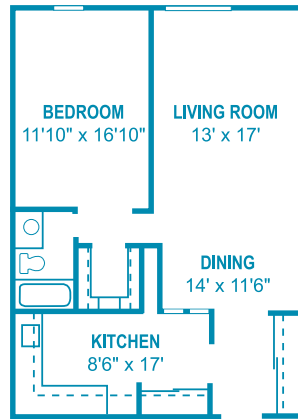

1 Bedroom, 1 bath, 925 sq. ft.

- One walk-in closet
- Two large closets
- Eat-in kitchen

\$ _____

ONE BEDROOM SUITE

Plan M

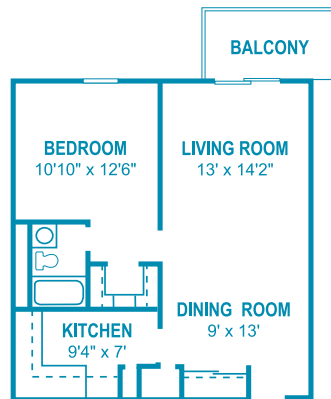

1 Bedroom, 1 bath, 702 sq. ft.

- One walk-in closet

\$ _____

TWO BEDROOM SUITE

Plan D

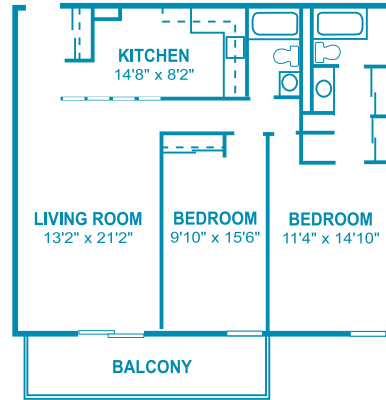

2 Bedrooms, 2 baths, 1068 sq. ft.

- Three large closets
- Large balcony
- Eat-in kitchen

\$ _____

TWO BEDROOM SUITE

Plan K

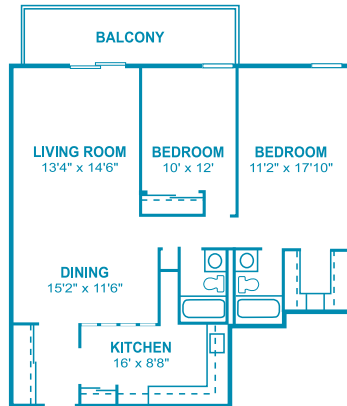

2 Bedrooms, 2 baths, 1068 sq. ft.

- One walk-in closet
- Eat-in kitchen
- Two large closets
- Large balcony

\$ _____

TWO BEDROOM SUITE

Plan N

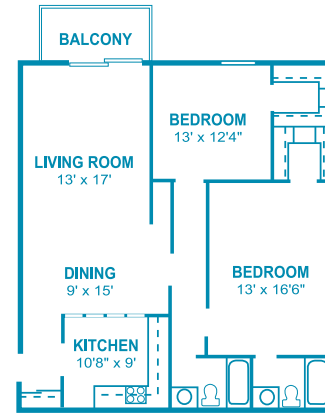

2 Bedrooms, 2 baths, 1140 sq. ft.

- Two walk-in closets
- Eat-in kitchen
- One large closet

\$ _____

THREE BEDROOM SUITE

Plan H

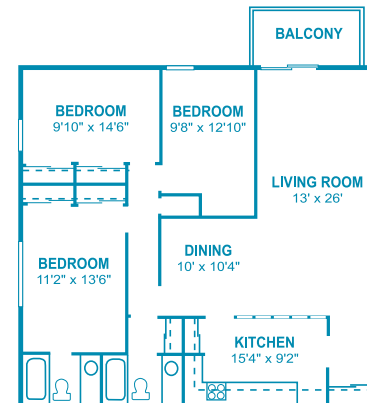

3 Bedrooms, 2 baths, 1368 sq. ft.

- Three large closets
- Eat-in kitchen

\$ _____

GRAFTON HILL
history awaits

THE ROCKWOOD

If you're looking for a rewarding place to call home, consider The Rockwood in the Grafton Hill Historic District – a location surrounded by tradition, yet as current as today.

Rockwood residents find it easy to experience and participate in the area's cultural attractions: Schuster Center, Oregon Entertainment District, Dayton Art Institute, and the 5/3 Field. Plus, Grafton Hill hosts the annual Panegyri Greek Festival and the Dayton Art Institute Oktoberfest.

Recreational activities like the River Corridor Bikeway, hiking/biking paths, tennis courts and numerous parks are just minutes away. The Rockwood offers spacious one, two, and three bedroom suites and studios with unique floor plans, some with living rooms large enough for a baby grand piano.

Each apartment features wall-to-wall carpet, a fully-equipped kitchen, ceiling fan, individual temperature control and an intercom system. Plus, all apartments are cable-ready and heat and water is paid. Laundry facilities are conveniently located on every floor. Indoor parking with electric garage door openers, sparkling pool, community room with wide-screen TV, 24-hour closed-circuit TV monitors, and 24-hour emergency maintenance are part of The Rockwood's amenity package.

History awaits atop Grafton Hill. But don't you wait – come home to The Rockwood today.

Leasing Office is located at
531 Belmonte Park North.

EASY ACCESS TO I-75
515 W. Grand Avenue
Dayton, Ohio 45405

937.222.4511
www.towneprop.com/rockwood

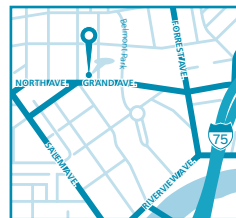

A Great Place to Live by Towne Properties®



TWO BEDROOM SUITE *Plan C*

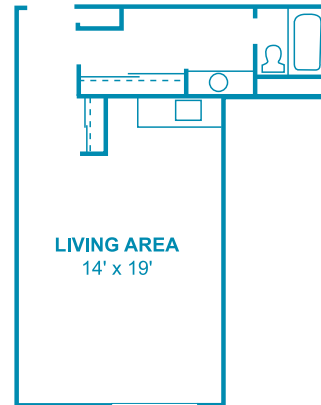

Studio, 1 bath, 510 sq. ft.

\$ _____

TWO BEDROOM SUITE *Plan L*



Studio, 1 bath, 574 sq. ft.

\$ _____

TWO BEDROOM SUITE *Plan B*

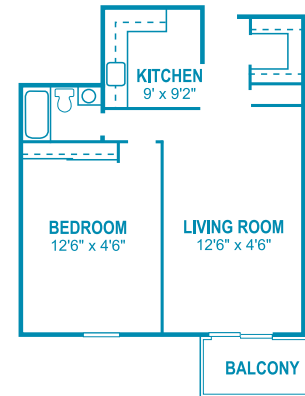

1 Bedroom, 1 bath, 718 sq. ft.

- One walk-in closet
- One large closet

\$ _____

THREE BEDROOM SUITE *Plan E*

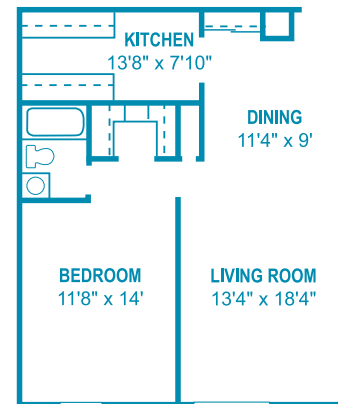

1 Bedroom, 1 bath, 784 sq. ft.

- One walk-in closet
- One large closet
- Eat-in kitchen

\$ _____

TWO BEDROOM SUITE *Plan F*

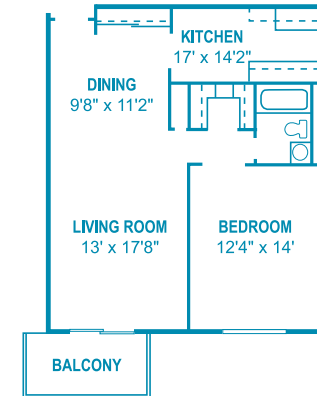

1 Bedroom, 1 bath, 788 sq. ft.

- One walk-in closet
- One large closet
- Eat-in kitchen

\$ _____

THREE BEDROOM SUITE *Plan I*

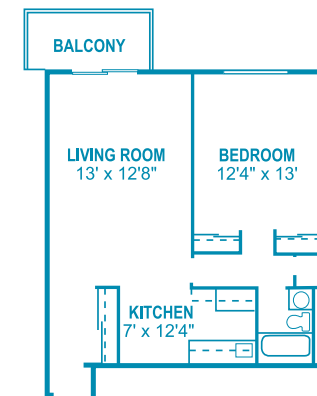

1 Bedroom, 1 bath, 698 sq. ft.

- Three large closets
- Eat-in kitchen

\$ _____